

2024 Hospital Seismic Performance Report

AB 1882

AB 1882 Purpose – Services and Performance Ratings

Assembly Bill 1882 requires each general acute care hospital operator to annually report the structural and non-structural performance ratings for each individual hospital building used for providing care, and services housed in each. Hospital operators are responsible to provide their report to specific public entities and hospital stakeholders until seismic compliance is achieved for all buildings.

This document includes a brief explanation of Structural and Non-structural Performance Ratings, along with details about services offered by the hospital. Additionally, it outlines the specific entities and stakeholders to whom the facility is required to submit the report. Furthermore, the document contains the facilities' site plan, building numbers and names, and a comprehensive table detailing the ratings of acute care services housed within each building.

Structural and Non-structural Performance Ratings: The Structural Performance Category (SPC) of a hospital building, akin to bones and muscles in the human body, signifies its primary strength and stability, ranging from the strongest SPC-5 to the weakest SPC-1. Non-structural Performance Category (NPC), like organs in the human body, includes systems and equipment vital for daily operations, rated from functional NPC-5 to system risk to life NPC-1. Both SPC and NPC are crucial, collectively defining a hospital's effectiveness and quality of care.

Acute Care Services: General acute care services are grouped into four categories:

- Required clinical services: Nursing, Surgery, Anesthesia, Imaging, Laboratory, Pharmacy, Dietetic
- Required support services: Administration, Environmental Services, General Stores, Linen, Morgue
- Supplemental services – optional services requiring special licensure: Critical Care, Emergency, Pediatric, Psychiatric, Obstetric, Rehabilitation, Skilled Nursing, others
- Infrastructure – buildings that provide utilities and support circulation: Central Plants, canopies, corridor buildings, tunnels, skybridges

Report Distribution: Hospitals are required to issue reports to the following organizations and stakeholders:

- Local county board of supervisors
- Local city council, if applicable
- Any labor union representing employees working in buildings not fully conforming
- Special district or joint power agencies providing fire and emergency medical services district, if applicable
- Department of Health Care Access and Information
- Board of directors of the hospital
- Local office of emergency services or equivalent
- Office of Emergency Services
- Medical health operational area coordinator

12285 Rady Children's Hospital - San Diego

Bldg Num	Bldg Name	Applicable Year	Nursing Med Surg	Surgical	Anesthesia PACU	Clinical Lab	Imaging Radiological Diagnostic Imaging	Pharmacy	Dietetic	Administrative	Sterile Processing	General Storage	Morgue	Employee Dressing	Housekeeping EVS	Laundry Linen	Special Procedures	ICU CCU PICU	Burn Unit	Neonatal Intensive Care Unit	Pediatric Adolescent Nursing Unit	Psychiatric Nursing	Obstetrics Perinatal Unit	Emergency	Nuclear Medicine	Rehabilitation Therapy	Physical Rehabilitation Nursing Unit	Renal Dialysis	Respiratory	Intermediate Care	Outpatient Services	Skilled Nursing Unit	Central Plant Utility Bldg	Canopies Corridor Buildings Tunnels	Non GAC Uses	
BLD-02066	Dining Room - Original Hospital	2024																																IT Offices	SPC: 2 NPC: 3 This building does not significantly jeopardize life, but may not be repaired..	
BLD-02070	2nd Dining Room - Original Hospital	2024																																IT Offices	SPC: 4 NPC: 3	
BLD-02071	Intensive Care Unit	2024					X																							X					SPC: 4 NPC: 3	
BLD-02072	Co-Generation Plant	2024																														X			SPC: 4 NPC: 3	
BLD-02073	Clinical Lab	2024				X							X																				X			SPC: 3 NPC: 3
BLD-02076	Radiology Addition	2024					X	X				X		X		X									X					X						SPC: 3 NPC: 3

12285 Rady Children's Hospital - San Diego

Bldg Num	Bldg Name	Applicable Year	Nursing Med Surg	Surgical	Anesthesia PACU	Clinical Lab	Imaging Radiological Diagnostic Imaging	Pharmacy	Dietetic	Administrative	Sterile Processing	General Storage	Morgue	Employee Dressing	Housekeeping EVS	Laundry Linen	Special Procedures	ICU CCU PICU	Burn Unit	Neonatal Intensive Care Unit	Pediatric Adolescent Nursing Unit	Psychiatric Nursing	Obstetrics Perinatal Unit	Emergency	Nuclear Medicine	Rehabilitation Therapy	Physical Rehabilitation Nursing Unit	Renal Dialysis	Respiratory	Intermediate Care	Outpatient Services	Skilled Nursing Unit	Central Plant Utility Bldg	Canopies Corridor Buildings Tunnels	Non GAC Uses	
BLD-02079	Children's Way Pavilion (15A & 15B)	2024	X							X								X						X						X						SPC: 3 NPC: 3
BLD-02080	Childrens Way Pavilion - Clock Tower	2024																															X			SPC: 4 NPC: 3
BLD-02669	Surgical Unit	2024			X				X								X													X						SPC: 4 NPC: 3
BLD-02770	Gas Storage Building	2024										X																								SPC: N/A NPC: 4
BLD-02772	Bridge to Acute Care Pavilion	2024																															X			SPC: 5 NPC: 4
BLD-02773	Emergency Generator Building	2024																														X				SPC: 5 NPC: 4

12285 Rady Children's Hospital - San Diego

Bldg Num	Bldg Name	Applicable Year	Nursing Med Surg	Surgical	Anesthesia PACU	Clinical Lab	Imaging Radiological Diagnostic Imaging	Pharmacy	Dietetic	Administrative	Sterile Processing	General Storage	Morgue	Employee Dressing	Housekeeping EVS	Laundry Linen	Special Procedures	ICU CCU PICU	Burn Unit	Neonatal Intensive Care Unit	Pediatric Adolescent Nursing Unit	Psychiatric Nursing	Obstetrics Perinatal Unit	Emergency	Nuclear Medicine	Rehabilitation Therapy	Physical Rehabilitation Nursing Unit	Renal Dialysis	Respiratory	Intermediate Care	Outpatient Services	Skilled Nursing Unit	Central Plant Utility Bldg	Canopies Corridor Buildings Tunnels	Non GAC Uses	
BLD-03127	C Wing - Original Hospital	2024																			X															SPC: 2 NPC: 3 This building does not significantly jeopardize life, but may not be repaired..
BLD-03128	D Wing - Original Hospital	2024													X												X			X						SPC: 2 NPC: 3 This building does not significantly jeopardize life, but may not be repaired..
BLD-03130	Trauma Room Addition	2024												X																						SPC: 3 NPC: 3
BLD-03195	Intensive Care Unit	2024																X																		SPC: 4 NPC: 3
BLD-03197	Passageway to NICU	2024																															X			SPC: 3 NPC: 3
BLD-03198	Children's Way Pavilion - Bridge	2024																															X			SPC: 3 NPC: 3

12285 Rady Children's Hospital - San Diego

Bldg Num	Bldg Name	Applicable Year	Nursing Med Surg	Surgical	Anesthesia PACU	Clinical Lab	Imaging Radiological Diagnostic Imaging	Pharmacy	Dietetic	Administrative	Sterile Processing	General Storage	Morgue	Employee Dressing	Housekeeping EVS	Laundry Linen	Special Procedures	ICU CCU PICU	Burn Unit	Neonatal Intensive Care Unit	Pediatric Adolescent Nursing Unit	Psychiatric Nursing	Obstetrics Perinatal Unit	Emergency	Nuclear Medicine	Rehabilitation Therapy	Physical Rehabilitation Nursing Unit	Renal Dialysis	Respiratory	Intermediate Care	Outpatient Services	Skilled Nursing Unit	Central Plant Utility Bldg	Canopies Corridor Buildings Tunnels	Non GAC Uses	
BLD-03647	Acute Care Pavilion	2024	X	X	X		X	X		X	X	X		X			X			X										X		X				SPC: 5 NPC: 4
BLD-03896	Hahn Pavilion Loading Dock Canopy	2024																															X			SPC: 3 NPC: 3

Rady Children's Hospital - San Diego

Facility No. 12285

11/3/2023

- LEGEND:
- NON-ACUTE CARE BUILDING

SEISMIC SEPARATION JOINT

EDGE OF BUILDING

CONSTRUCTION JOINT

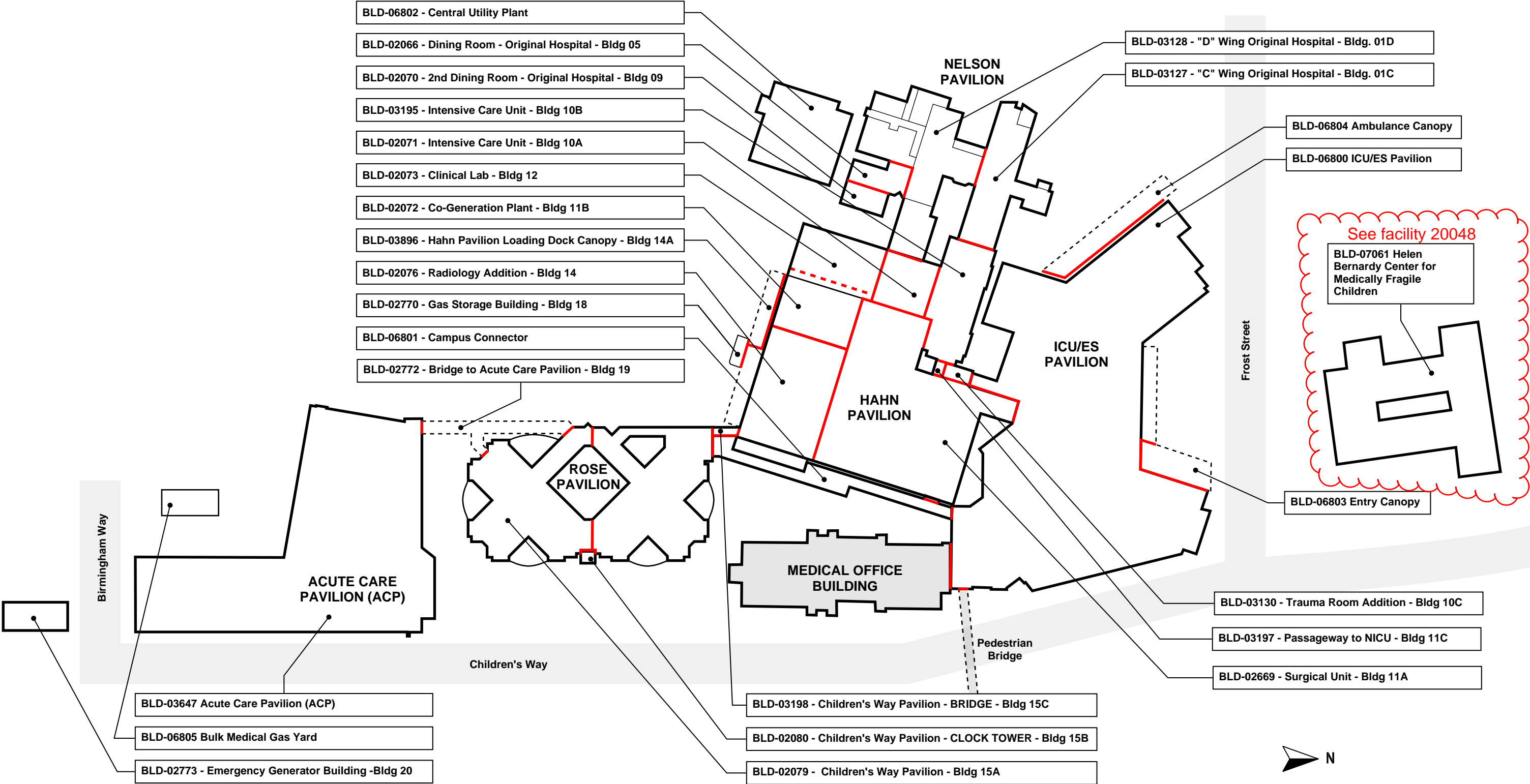

General Acute Care Hospital Building Services – Glossary

Service Category	Description
<u>Basic Clinical Services</u>	<u>Required for hospital licensure</u>
Nursing - General Medical/Surgical	General inpatient nursing bed units. <ul style="list-style-type: none"> Includes post-intensive care or transitional care/telemetry units Excludes specialty nursing units
Surgical	Surgery Department - <ul style="list-style-type: none"> Includes patient preparation unit and operating rooms Hybrid operating rooms (in-room CT, MRI, other intraoperative surgery modalities)
Anesthesia, Post Anesthesia Care Unit	Post surgery recovery unit
Clinical Laboratory	Laboratory services
Imaging, Radiological/Diagnostic Imaging	X-Ray, Fluoroscopy, CT, MRI, Ultrasound, Mammography
Pharmacy	Main Pharmacy <ul style="list-style-type: none"> Excludes in-unit medication rooms
Dietetic	Patient meal preparation kitchen, serverly & dining <ul style="list-style-type: none"> Includes emergency food storage location Excludes snack bars, unit food storage & break rooms

<u>Basic Support Services</u>	<u>Required for hospital operations</u>
Administration	Main hospital administration location <ul style="list-style-type: none"> Excludes department administration
Sterile Processing	Main instrument sterilization, reprocessing and sterile storage
General Storage	Main Materials Management single location <ul style="list-style-type: none"> Includes loading dock, gas storage and similar general storage locations Excludes unit and specialty storage uses
Morgue	Includes morgue, autopsy, pathology and body holding. Not required for all facilities.
Employee Dressing	Locker rooms
Housekeeping/Environmental Services	Main Environmental Services Office location
Laundry/Linen	Laundry, or Main Linen Storage location if using offsite laundry services
<u>Supplemental Services</u>	<u>Optional clinical services</u>
Special Procedures	Cardiac Catheterization Labs, Interventional Radiology, Angiography
Intensive Care/Coronary Care/Pediatric ICU	Critical care inpatient nursing units for general, cardiovascular or pediatric patients

Burn Unit	Specialized inpatient critical care unit with specialized capability to treat burns
Neonatal Intensive Care Unit (NICU)	Specialized intensive care unit for newborns
Pediatric/Adolescent Nursing Unit	Principal bed type for Children's' Hospital or specialized unit if in a general acute care hospital
Psychiatric Nursing	Specialized inpatient unit for acute psychiatric patients
Obstetrics/Perinatal Unit	<p>Specialized inpatient units for birthing.</p> <ul style="list-style-type: none"> Includes labor rooms, delivery rooms, C-Section rooms, post-partum rooms, Labor, Delivery and Recovery Rooms (LDR's), Labor, Delivery, Recovery & Post-Partum Rooms (LDRP's) and well-baby nurseries
Emergency	<p>Emergency Departments</p> <ul style="list-style-type: none"> Includes Trauma Rooms
Nuclear Medicine	Specialized inpatient and outpatient imaging and cardiac testing
Rehabilitation Therapy	<p>Therapy services for inpatients and outpatients</p> <ul style="list-style-type: none"> Includes Physical Therapy (PT), Occupational Therapy (OT) and Speech Therapy
Physical Rehabilitation Nursing Unit	Specialized inpatient unit for Acute Rehabilitation patients with therapy to support return to normal daily living

Renal Dialysis	<p>Centralized inpatient/outpatient unit for providing dialysis care.</p> <ul style="list-style-type: none"> Excludes bedside dialysis care
Respiratory Care	Respiratory Care department's main office and specialized storage
Intermediate Care	<p>Specialized long-term inpatient care for developmentally disabled persons or those not requiring skilled nursing. Uncommon in general acute care hospitals</p>
Outpatient Services	Unspecified licensed outpatient services provided in a hospital building
Skilled Nursing Care	Post-acute long term skilled nursing units
<u>Infrastructure</u>	<u>Support for site operations</u>
Central Plan/Utility Buildings	<p>Buildings providing principal utility origination</p> <ul style="list-style-type: none"> Includes central plants, boiler, electrical and chiller buildings, utility yards, bulk oxygen vessels, pump houses, etc. Includes main computer server rooms Excludes distributed utility closets
Canopies/Corridor Buildings/Tunnels	<p>Hospital buildings supporting circulation. Includes</p> <ul style="list-style-type: none"> structurally free-standing canopies buildings that only house connecting corridors underground tunnels <p>Excludes:</p> <ul style="list-style-type: none"> Canopies attached to other structures Corridors in buildings with other occupiable uses