





3738 BAYER AVE, SUITE 104  
LONG BEACH, CA 90806  
T 562.595.5566 | F 562.595.5577  
CONSULTANT

KINDRED HOSPITAL -  
WESTMINSTER

200 HOSPITAL CIRCLE  
WESTMINSTER, CA. 92683  
NPC-5 UPGRADES

REVISIONS

AGENCY NO. H250800-30-00

DPOR SEAL / MILESTONE

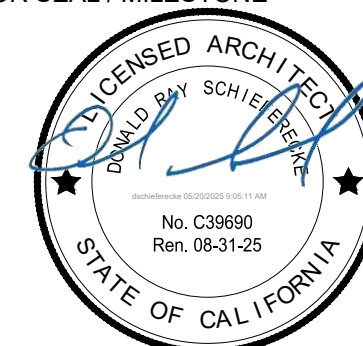

PROJECT NO. 1783.11  
DRAWN JW, RK, SN  
REVIEWED DS, NA

SITE PLAN

A100

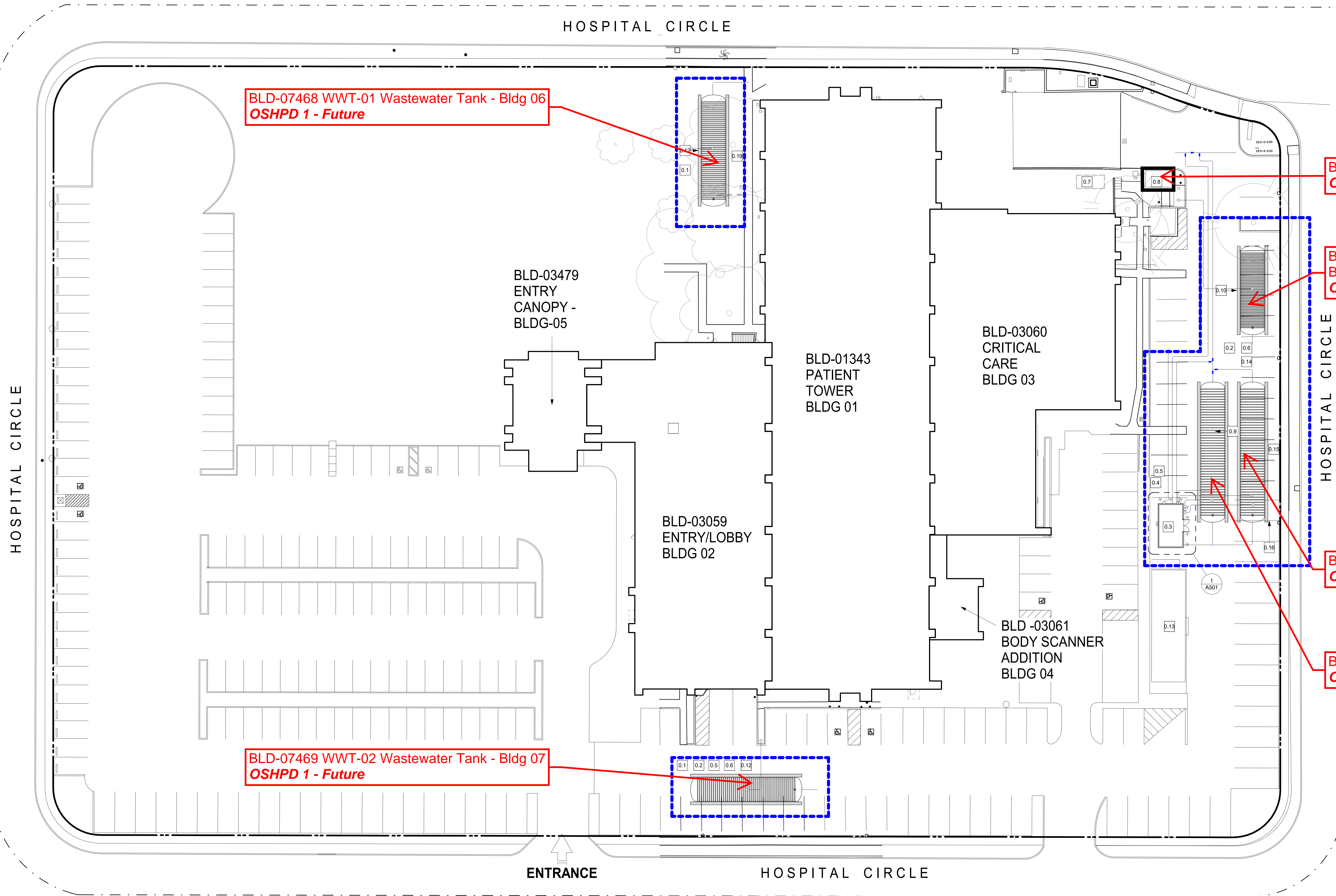

SITE PLAN SCALE: 1" = 20'-0"

1

### SITE GENERAL NOTES

CONTRACTOR SHALL FIELD VERIFY ALL EXISTING CONDITIONS PRIOR TO THE START OF CONSTRUCTION AND NOTIFY THE ARCHITECT OF ANY DISCREPANCIES, CONFLICTS OR RESTRICTIONS THAT MAY AFFECT THE ACCESSIBILITY OF COMPLICATED PROJECT IMPROVEMENTS. IN ADDITION, THE CONTRACTOR SHALL KNOW AND BE FAMILIAR WITH ALL APPLICABLE BUILDING AND ACCESSIBILITY CODES AND IS RESPONSIBLE FOR INSURING THEIR WORK IS IN COMPLIANCE WITH SUCH.

### SITE PLAN LEGEND

--- LIMIT OF WORK  
--- RIGHT-OF-WAY  
--- CENTERLINE

### KEYNOTES

- EXCAVATE AND REPLACE WITH PROPERLY COMPACTED FILL PER GEOTECH DIRECTION.
- PATCH AND REPAIR ASPHALT PAVING AND CONCRETE CURB TO MATCH EXISTING.
- NEW CONCRETE PAD - 4" ABOVE FINISH ASPHALT PAVING. VERIFY CONCRETE PAD DIMENSIONS WITH MANUFACTURER. REFER TO PH-1 ON PLUMBING DRAWINGS.
- PUMPHOUSE ELECTRICAL PANEL. REFER TO ELPH-1 ON ELECTRICAL DRAWINGS.
- PROVIDE TRAFFIC PLATES AT CONDUIT TRENCH DURING CONSTRUCTION.
- PROVIDE K-RAIL OR SIMILAR CONSTRUCTION BARRIER AT PERIMETER TRENCH AS REQUIRED.
- (E) EMERGENCY GENERATOR.
- (E) 4000 GALLON EMERGENCY GENERATOR UNDERGROUND FUEL TANK.
- 12" DIAMETER, 68' LONG 50,000 GALLON UNDERGROUND WATER STORAGE TANK.
- 12" DIAMETER, 43' LONG 30,000 GALLON UNDERGROUND WASTE STORAGE TANK.
- PUMP HOUSE. REFER TO PH-1 ON PLUMBING DRAWINGS.
- 40,000 GALLON, 12" DIAMETER, 54' LONG UNDERGROUND WASTE STORAGE TANK.
- (E) BULK OXYGEN STORAGE.
- PROVIDE WARNING SIGN PROHIBITING OPEN FLAMES AND SMOKING. WARNING SIGN SHALL BE IN ENGLISH AS A PRIMARY LANGUAGE. OR IN SYMBOLS ALLOWED BY CODE, SIZE, COLOR, AND LETTERING SHALL BE APPROVED. CFS 5704.2-3, 5703.5, AND 5003.7.
- (E) SIGNS AND WHEELSTOPS TO BE REMOVED AND REPLACED WHERE APPLICABLE.
- NEW PARKING STRIPING AT AREAS OF REPAVING, TYP.
- TREE REMOVAL PER CIVIL DRAWINGS. PLANT NEW TREE, LOCATION TBD BY OWNER/ARCHITECT.

### PARKING COUNT:

TOTAL NUMBER OF EXISTING PARKING STALLS - 254  
TOTAL NUMBER OF EXISTING ACCESSIBLE STALLS - 8 (NO CHANGE)  
TOTAL NUMBER OF PARKING STALLS AFTER PROPOSED NPC-5 UPGRADE - 251 (3 PARKING STALLS REDUCTION)

### LEGEND:

OSHPD 1