

La Palma Intercommunity Hospital Facility No. 13019

3/19/2026

BLD-00985 - Service Building
- Bldg 04
OSHPD 1 - SPC 4 NPC 2

BLD-02759 - Rehabilitation
Department Expansion - Bldg 05
OSHPD 1 - SPC 4 NPC 4D-L1

BLD-05782 - Canopy - Bldg 08
OSHPD 1 - SPC 5 NPC 4

BLD-05516 - Oxygen Tank
Yard - Bldg 07
OSHPD 1 - SPC N/A NPC 2

BLD-02758 - Service Building
- Bldg 04A
OSHPD 1 - SPC 4s NPC 2

BLD-02760 - Patient Room Expansion
- Bldg 06
OSHPD 1 - SPC 4 NPC 4D-L1

BLD-00984 - Pool Building - Bldg 03
OSHPD 1 - SPC 4 NPC 4D-L1

BLD-00982- Main
Building - Bldg 01
OSHPD 1 - SPC 2 NPC 2

BLD-00983 - Perinatal Building
Addition - Bldg 02
OSHPD 1 - SPC 4 NPC 4D-L1

Canopy

covered walkway

LEGEND:

OSHPD 1

OSHPD 1 - SPC 1 or SPC 2

Seismic Separation

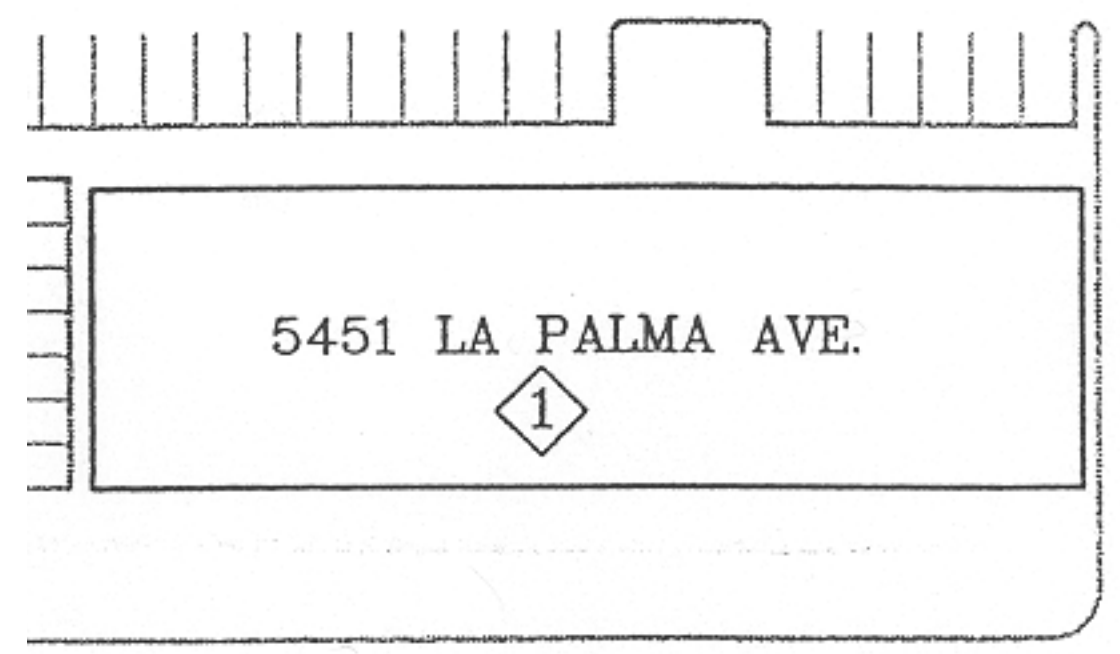

LA PALMA AVE.



