

# Mission Valley Post Acute Facility No. 21333

12/5/2023

BLD-04361 - Main Building - Bldg 01

## VICINITY MAP

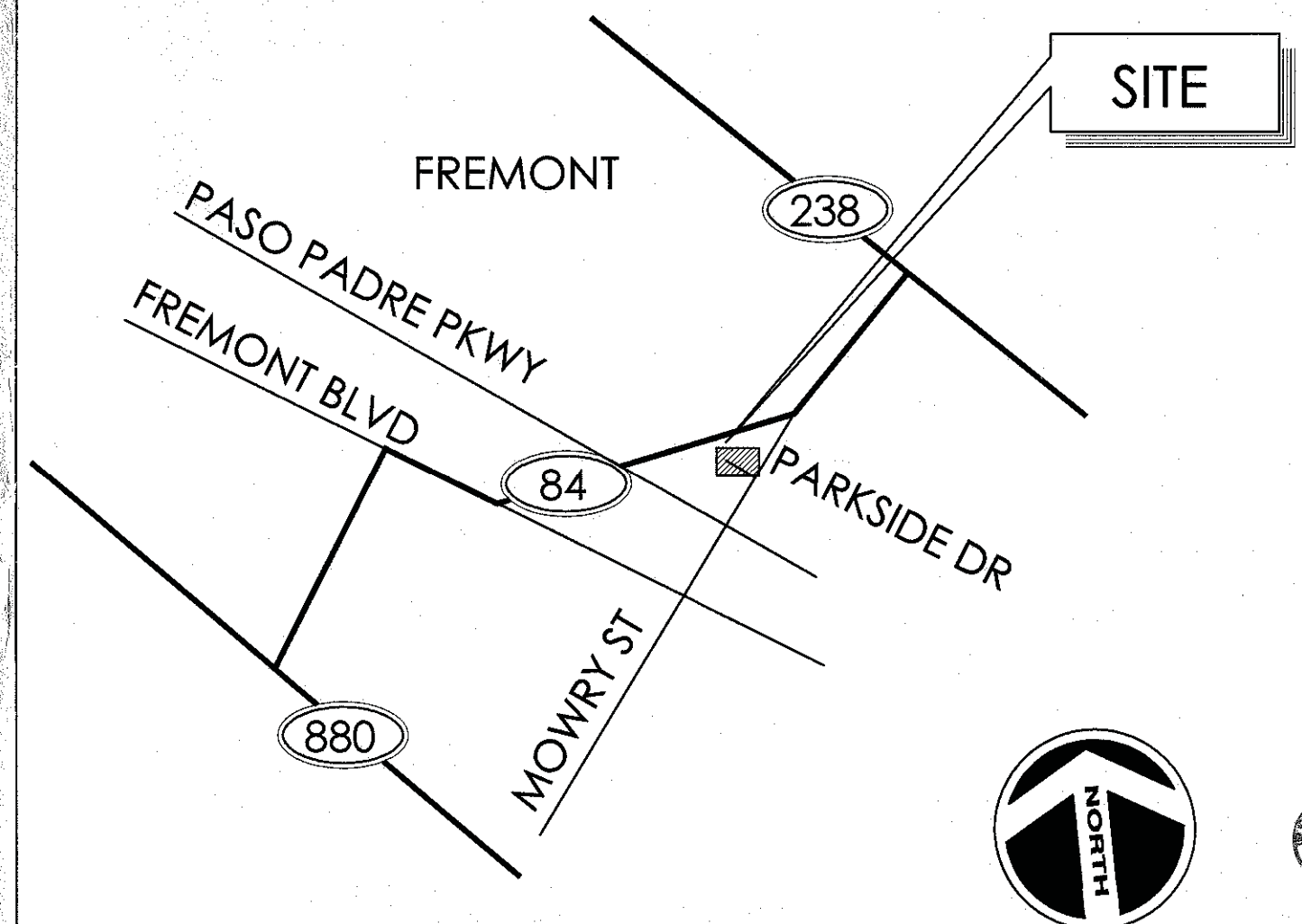

## SITE PLAN

NOTE: PER CBC 11B-202.4 (EXCEPTION 7) THIS PROJECT IS EXEMPT FROM ADDITIONAL ACCESSIBILITY REQUIREMENTS

1 HR RATED FIRE PARTITION, TYP.

1 HR RATED SMOKE BARRIER, TYP.

(E) ACCESSIBLE PATH OF TRAVEL/ MEANS OF EGRESS

AREA OF DAMAGED WASTE LINE TO BE REPLACED, SEE ENLARGED PLAN 1/A-1.0

(E) ACCESSIBLE ENTRANCE



OSHPD/FDD-Field Review Tracking					
Project:					
PAD:	AC	D	X	Rel	
AC:	AC	D	X	Rel	
Architectural:	AC	D	X	Rel	
Mechanical:	AC	D	X	Rel	
Electrical:	AC	D	X	Rel	
DSE:	AC	D	X	Rel	
Structural:	AC	D	X	Rel	
FLSO:	AC	D	X	Rel	
Fire Life Safety:	AC	D	X	Rel	



SCALE: 1/16"=1'-0"

## SITE/FLOOR PLAN